

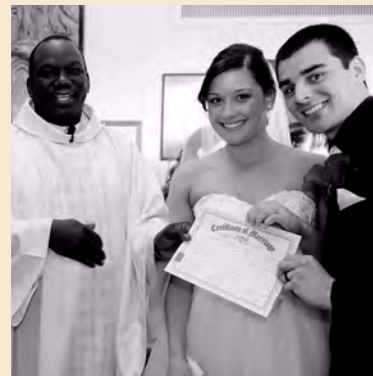

HONOR *the* PAST  
EMBRACE *the* PRESENT  
SECURE *the* FUTURE

CELEBRATING 100 YEARS *of* FAITH



CASE STATEMENT

## A MESSAGE *from* OUR PASTOR

*Jambo Rafikis,*

St. John the Evangelist Parish and School has a proud tradition spanning nearly a century. Thousands of parish and school families have contributed to making our community what it is today. We are especially thankful to those who have gone before us. Their commitment and sacrifice helped set the foundation for our welcoming, vibrant and faith-filled parish community.

Over the last year, we have analyzed the current state of our facilities. Parish and school leadership sought and received input and direction from staff, parishioners and school families. We have conducted “discovery workshops” to gather feedback on how to best implement our master plan and moved prudently, seeking professional guidance every step of the way.

*As we complete our 100th year, our parish has the opportunity to secure the future of St. John by maximizing the space of our current buildings to better serve our faith community.*

Revisiting our past is a reminder that St. John has always been a responsible steward of our resources. St. John families respond with generosity and sacrifice when called upon. It is with that call to action that I am proud to announce the *Honor the Past, Embrace the Present, Secure the Future* Capital Campaign.

I ask you to join me in prayerfully supporting our parish and school in this effort. As you contemplate your involvement in this important campaign, please think about what a blessing your Catholic faith is to you and your family. Think of those who worked tirelessly and made many sacrifices to make our community what it is today. I ask you to consider the kind of impact you will make. I am confident our parish family will respond with a profound generosity and sacrifice, just as generations before us have done.

Baraka ya Yesu,

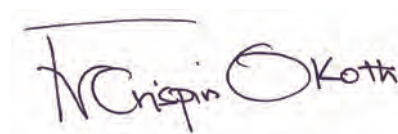

PADRE CRISPIN A. OKOTH  
*Pastor*





**1032**

*Number of families  
in the parish*



**528**

*Number of students  
in the school*



**30**

*Number of parish ministries*



**15-17**

*Number of meetings that  
are held each day throughout  
the parish and school*



## WHO WE ARE

For nearly 100 years, St. John the Evangelist has prided itself on being an inclusive Catholic community. As parishioners, we are guided by our mission. We worship together, celebrate the Eucharist together, pray together and develop our faith together. We pledge to serve people of all ages and life situations, perform good works, be good stewards, and express the gifts given to us by God.



## WHERE WE ARE

St. John the Evangelist is blessed with a thriving community.

A changing neighborhood has translated into growth in our church and school. While positive for our future, this increase strains our facilities. As our parish nears its 100-year anniversary, we have outgrown some of our current spaces and our buildings need updating.

Parish leaders have been proactively studying this situation, undertaking an extensive planning process to explore the long-term needs facing our church and school.

In April 2016, “discovery workshops” were held to gather feedback from parishioners, leadership committee members, faculty and staff. After an extensive review of those findings, a plan was developed to build a foundation for the next century.

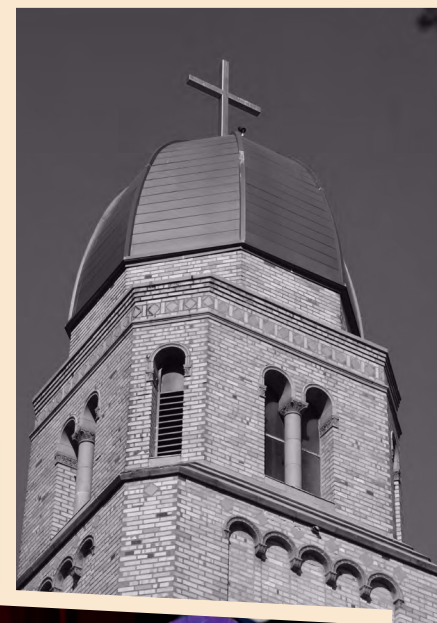

*“We have such a great in-City complex, but we need to upgrade and improve, building on what our previous Parishioners left us. We roll up our sleeves and keep the Parish improving!”*

SUZIE BURKE



## THE VISION

*At St. John the Evangelist, we find ourselves at an exciting juncture in 2017. As a parish and school community, we are ready to take on the challenge of implementing our plan.*

The vision will be made possible through the *Honor the Past, Embrace the Present, Secure the Future* Capital Campaign. This fundraising effort seeks to mark 100 years of faith by undertaking the following projects for our church and school.



*First floor*

### RECTORY RENOVATION and RESIDENCE RELOCATION *Estimated Cost: \$1,387,000*

#### NEED

Originally built to house four priests and one housekeeper, the over 4000-square-footage rectory is now occupied by one priest. Meanwhile, parish staff and ministries struggle to find space for day-to-day activities. The rectory needs to be utilized more efficiently.



#### PLAN

The first step of our campaign plan is the relocation of the rectory. Before renovations can begin, comfortable accommodations must be made for our current pastor. The parish will purchase or rent property in the neighborhood. The possibility of sharing rectory space with another parish is also under consideration. The new rectory arrangement must be suitable to Fr. Crispin and approved by the Archbishop.

Once the priest residence has been transitioned, renovation of the current building will begin. The rectory renovations will include:

- New office space for twelve
- Two new ADA restrooms
- New conference rooms
- A reception area
- Additional storage

#### BENEFIT

First and foremost, the parish will be able to maximize the space inside this building. The renovation will localize the parish and some school administrative staff in an easily accessible administration building. Relocation of the parish offices will pave the way for the remodel of Quigley House.







*Second Floor*



*Basement*

LOCALIZE STAFF IN AN EASILY ACCESSIBLE  
ADMINISTRATION BUILDING



“The relocation of the rectory and renovation of the current house makes perfect sense. It is a wonderful idea that frees up space that we desperately need.”

FR. CRISPIN

## THE VISION

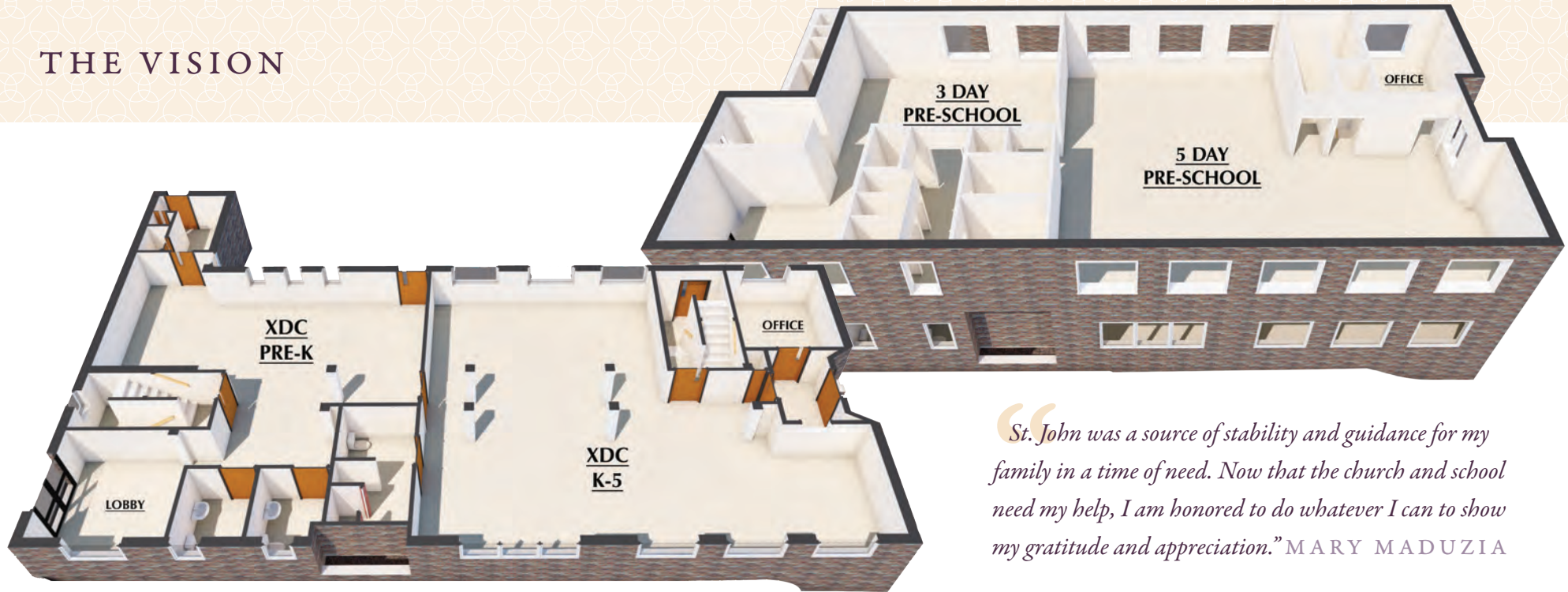

*“St. John was a source of stability and guidance for my family in a time of need. Now that the church and school need my help, I am honored to do whatever I can to show my gratitude and appreciation.”* MARY MADUZIA

### QUIGLEY HOUSE RENOVATION *Estimated Cost: \$1,420,000*

#### NEED

The current arrangement of preschool and extended care is challenging logistically and academically. Valuable educational minutes are lost transitioning between buildings. Collaboration between early childhood faculty is problematic in their current locations. Additionally, our campus plan calls for long overdue seismic improvements to Quigley House. These improvements are a priority for the safety of staff and students.

#### PLAN

Renovation of Quigley House allows for the relocation of all preschool classes and extended care space. Improvements will bring the building up to current codes and include:

- Three-day preschool classroom
- Five-day preschool classroom
- Extended care space
- Kitchen
- Restroom renovations on both floors
- Seismic upgrades
- Installation of fire protection devices
- Storage and maintenance space in the basement

#### BENEFIT

Renovations will bring our youngest students under one roof. Seismic and fire safety upgrades will provide our students and staff a safe and protected environment. Light and bright preschool classrooms will be an attractive selling point as new families consider where they will raise their children in faith. Moving some of the current classes out of the main school building, opens the door for the further renovation of that building.

SEISMIC AND FIRE SAFETY UPGRADES WILL PROVIDE  
A SAFE AND PROTECTED ENVIRONMENT.





## PROVIDE A SECURE, COLLABORATIVE ENVIRONMENT

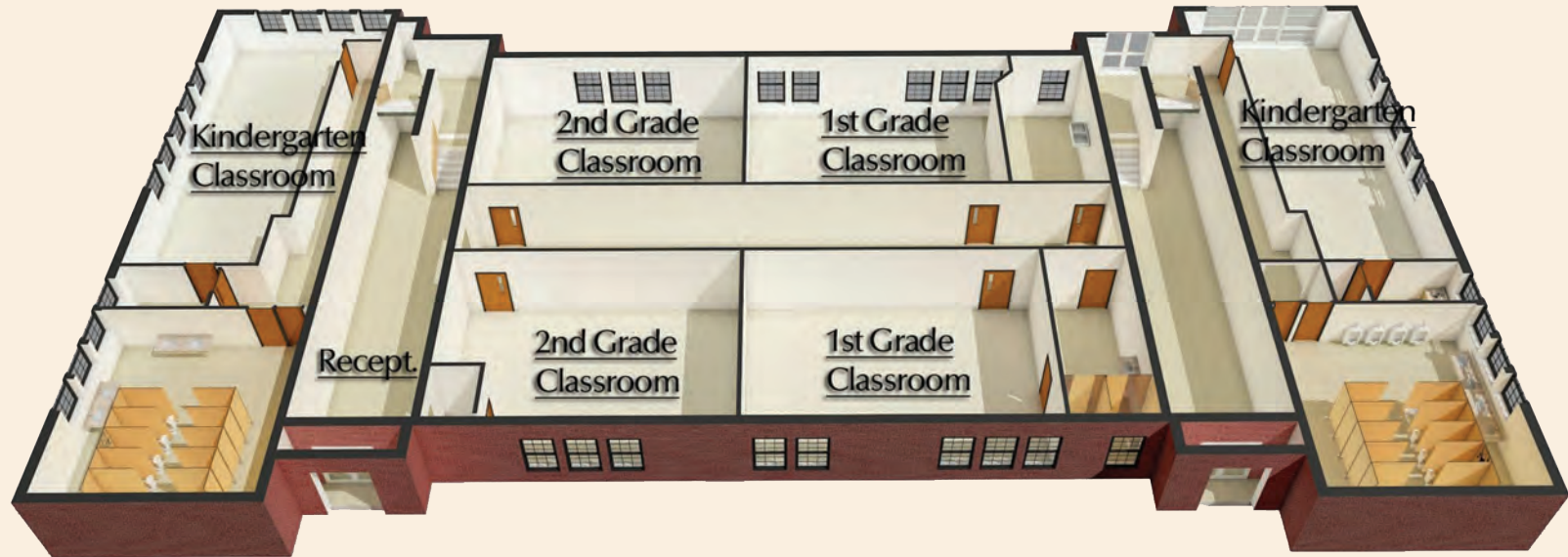

### FIRST FLOOR MAIN SCHOOL RENOVATION *Estimated Cost: \$459,000*

#### NEED

Kindergarten, first and second grade students are currently housed in the campus portables. The bathroom space is inadequate and the time needed to move students throughout campus during the day takes away from valuable class time. Additionally, the school does not have a clearly defined entrance for the public. This creates confusion and a potential security concern.



#### PLAN

Renovation of the first floor of the main school building will house kindergarten through second grade students and create a defined entrance off 79th street. School renovations include:

- Build four new classrooms in the current extended care space
- Convert the current school office into a fifth new classroom
- Renovate the current preschool area into a kindergarten classroom
- Create a school reception area open to 79th street

#### BENEFIT

Incorporating all K-8 students into one building provides a secure, collaborative environment. Time saved from moving children across campus creates more time for class instruction. A revamped entrance and reception area will be easier to access and safer for our students and staff.

The newly available space in the portables will provide for additional meeting space for various parish and school ministries, meetings, events, activities and storage.



## OUR GOALS



### CELEBRATION GOAL

*\$1,387,000*

RECTORY  
RENOVATION  
*and* RELOCATION



### CHALLENGE GOAL

*\$2,807,000*

QUIGLEY HOUSE  
RENOVATION



### VICTORY GOAL

*\$3,266,000*

FIRST FLOOR  
MAIN SCHOOL  
RENOVATION

*“We are excited to be a part of this project given how much St. John has done for our family. We can’t wait to see the benefits this will bring to our children, as well as all future St. John students!*

JOHN *and* ANNIE SALINAS

*St. John Parish is a vibrant faith and school community. There is a momentum and collective energy that can be sensed in our many ministries. A key component of keeping this spirit alive is our commitment to visionary planning for the future.*

PAUL *and* JESSICA KELLEY

*As grandparents, we are very grateful that we are doing what we need to do to provide a solid future for our Parish and School.*

FRANK *and* DEANN FEEMAN





## HOW YOU CAN HELP

### BUDGETING YOUR GIFT OVER THREE YEARS

3 Year Pledge	Initial 10% Investment	Remaining Balance	Weekly	PAYMENT PLAN		
				Monthly	Quarterly	Annual
\$100,000	\$10,000	\$90,000	\$577	\$2,500	\$7,500	\$30,000
\$50,000	\$5,000	\$45,000	\$288	\$1,250	\$3,750	\$15,000
\$24,000	\$2,400	\$21,600	\$138	\$600	\$1,800	\$7,200
\$15,000	\$1,500	\$13,500	\$87	\$375	\$1,125	\$4,500
\$12,000	\$1,200	\$10,800	\$69	\$300	\$900	\$3,600
\$9,000	\$900	\$8,100	\$52	\$225	\$675	\$2,700
\$7,200	\$720	\$6,480	\$42	\$180	\$540	\$2,160
\$6,000	\$600	\$5,400	\$35	\$150	\$450	\$1,800
\$4,500	\$450	\$4,050	\$26	\$113	\$338	\$1,350
\$3,600	\$360	\$3,240	\$21	\$90	\$270	\$1,080



### METHODS OF GIVING

#### *Pledges*

A campaign pledge is an agreement to fulfill a financial commitment over a period-of-time. To maximize the funding potential which may exist within our community, we are asking all our families to consider a three-year commitment in support of the *Honor the Past, Embrace the Present, Secure the Future* Capital Campaign. Pledges are obligations made in good faith, but are not legally binding. Pledge payments are tax deductible, as provided by law.

#### ○ Checks or cash

Are the most common form of payment, but St. John the Evangelist Parish and School also graciously accepts gifts in various forms including those listed here:

#### ○ Appreciated Securities

#### ○ Appreciated stock gifts offer advantageous tax savings

#### ○ Corporate Matching Gifts

A matching gifts program through your employer or board membership may allow you to increase the value of your gift. Many companies match charitable gifts of employees, retirees or board members. Check with your employer to see if there is a matching program available to increase your gift to the campaign.

#### *Other methods of giving:*

- Bonds and Mutual Funds
- Charitable Remainder Trust
- Deferred or Planned Gifts
- Gifts In-Kind
- Gifts of Life Insurance
- Gifts of Real Estate
- Gifts of Retirement Plans





# NAMING OPPORTUNITIES

At one time or another, someone special has touched our lives in some way. A truly gratifying experience is giving a gift in honor or in memory of someone important – someone who has influenced our development. St. John the Evangelist Parish and School have multiple opportunities to create lasting tributes to family and friends. This list of commemorative and naming opportunities offers the chance to remember someone important and make a difference for the students of tomorrow.

- |                                   |                |
|-----------------------------------|----------------|
| i. Six Student Classrooms         | \$100,000 each |
| ii. Three-day Preschool Classroom | \$75,000       |
| iii. Five-day Preschool Classroom | \$75,000       |
| iv. Extended Care                 | \$75,000       |

## DONOR RECOGNITION

- |                          |                      |
|--------------------------|----------------------|
| i. Centennial Circle     | \$100,000 or Higher  |
| ii. Crispin's Club       | \$50,000 to \$99,999 |
| iii. Principal's Partner | \$20,000 to \$49,999 |
| iv. Golden Benefactor    | \$10,000 to \$19,999 |
| v. Purple Patron         | \$3,600 to \$9,999   |
| vi. Friend of St. John   | up to \$3,599        |





## CAMPAIGN PRAYER

Almighty Father, you blessed your people most abundantly through the gift of your son, Jesus Christ, who offered his Body and Blood as the source of eternal life. Bless us as we continue to do your work at St. John the Evangelist Parish and School, especially during the *Honor the Past, Embrace the Present, Secure the Future* Capital Campaign. Help us to invest in our future, providing for our community dedicated to the sacrifice of your son.

We ask this through Christ, our Lord.

A M E N





## CAMPAIGN LEADERSHIP

### PASTOR

Rev. Crispin Okoth

### HONORARY CHAIRS

Frank and DeAnn Feeman

Suzie Burke

### CABINET MEMBERS

Mike and Jennifer Bachhuber

Matt and Amy BonDurant

Matt and Meg Deines

Peter and Angela Doyle

Paul and Jessica Kelley

Mary Maduzia

Bernadette O'Leary

Patrick and Kathleen Owens

John and Annie Salinas

Paul Singer and Carolyn Sherman

Peter and Jennifer Stankovich

Greg and Gretchen Swanson

John and Michele Thornquist

Matt and Marianne Wells

Larry and Mary Wiseman

### DEVELOPMENT COUNSEL

Anthony Schenk

Steier Group

